

600 NW Gilman Blvd, Suite E
Issaquah, WA 98027

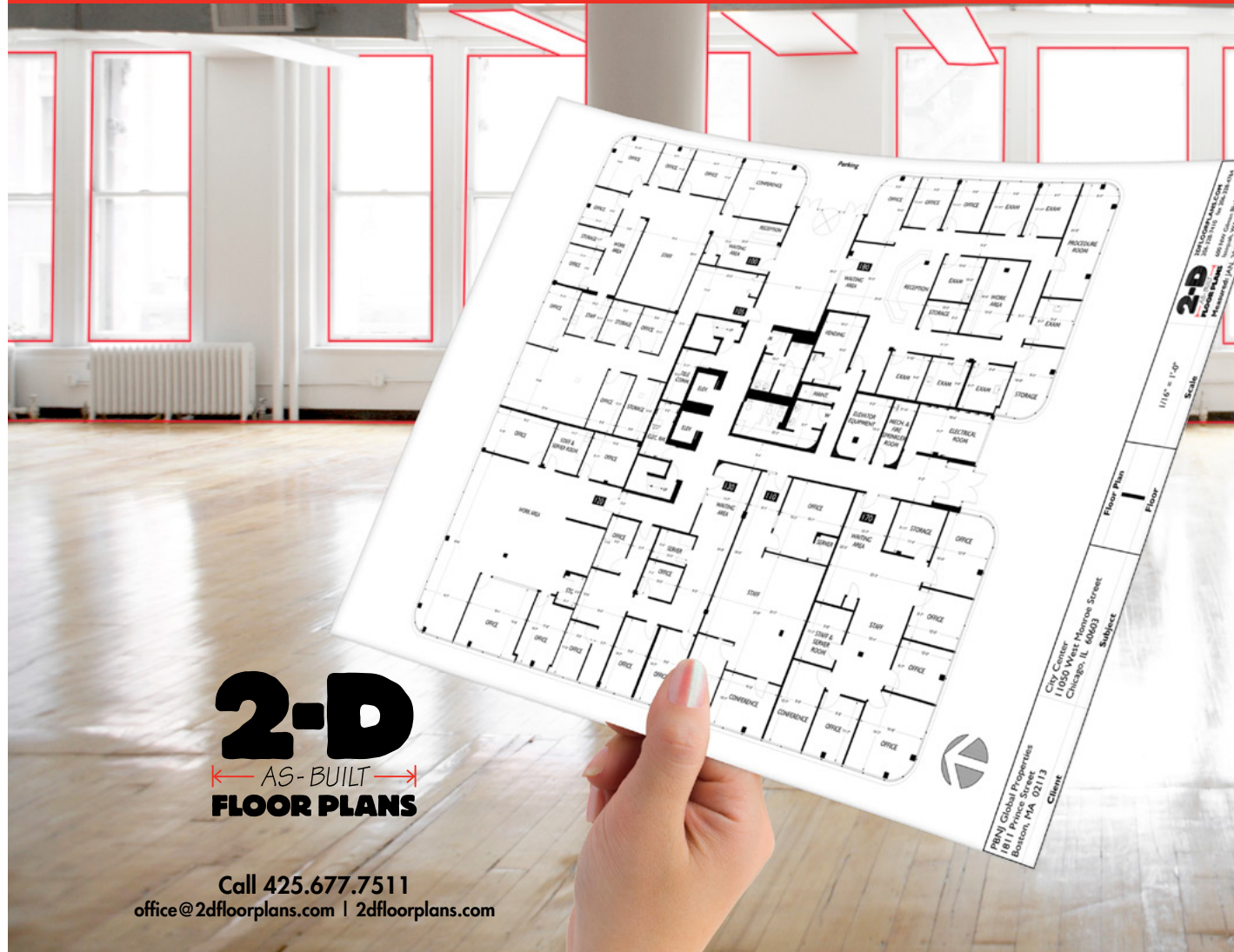

PROFESSIONAL BUILDING MEASUREMENT SERVICES

IMAGINE KNOWING YOUR BUILDINGS, EXACTLY.



Call 425.677.7511
office@2dfloorplans.com | 2dfloorplans.com

Client: PNY Global Properties
181 Prince Street
Boston, MA 02113

City: Center
1056 West Monroe Street
Chicago, IL 60603

Subject: Floor Plan

Scale: 1/16" = 1'-0"

2-D AS-BUILT FLOOR PLANS
Professional Plans
10000 Gilman Blvd, Suite E
Issaquah, WA 98027

BOMA Reports

We do a complete lease area analysis for building owners or managers, using the latest BOMA standard, calculating usable and rentable areas for each suite.

Our BOMA reports include:

- Full Floor Plans in Black & White
- Color-Coded Lease Plans
- Suite Drawings (upon request)
- CD with PDF and CAD Files
- Easy-to-Read Building Summary

Why our technology saves you money...

We never go to paper - our software records measurements via bluetooth directly into our pen tablet from a laser measuring device, creating an instant CAD file. This dramatic reduction in labor makes our as-builts fast and accurate, yet extremely cost effective.

Why you should have your building measured...

The revisions in the BOMA standard since 1996 have generally increased the rentable area of buildings by 2% to 5% simply as a result of remeasurement. This results in significantly more income and increases the value of the building. The payback period for investing in measuring may be the quickest of any investment in your building.



Floor Plans

For architects, 2-D has the capability to produce highly accurate as-builts to any set of standards, with locations of all details:

- Floor Plans
- Reflected Ceiling Plans
- Electrical Plans
- Site Plans
- Elevations
- Furniture Plans
- Evacuation Plans
- Marketing Plans

3-D Laser Scanning

- Revit Files
- 3-D Modeling
- Interior/Exterior Elevation Drawings
- Reflected Ceiling Plans
- Site/Landscape Plans
- Roof Plans
- Historical Preservation
- Point Cloud Production

Color-Coded Lease Plans

Our color-coded lease plans and spreadsheets clearly indicate tenant areas and common areas - the easiest to read in the industry.

